



**12.5 Acres of Peaceful Country Cemetery (south of Oshkosh)**

*A place where lives are commemorated, memories are made tangible, and tributes are paid to the life, not the death of loved ones.*



# Peace Lutheran Cemetery



100 W Waukau Ave  
Oshkosh, Wisconsin

**Open Sunrise to Sunset**

Mailing Address:  
240 W 9th Avenue, Suite 1  
Oshkosh, WI 54902

Phone: 920-420-7946

Fax: 920-231-4823

Email: [plcoffice@new.rr.com](mailto:plcoffice@new.rr.com)

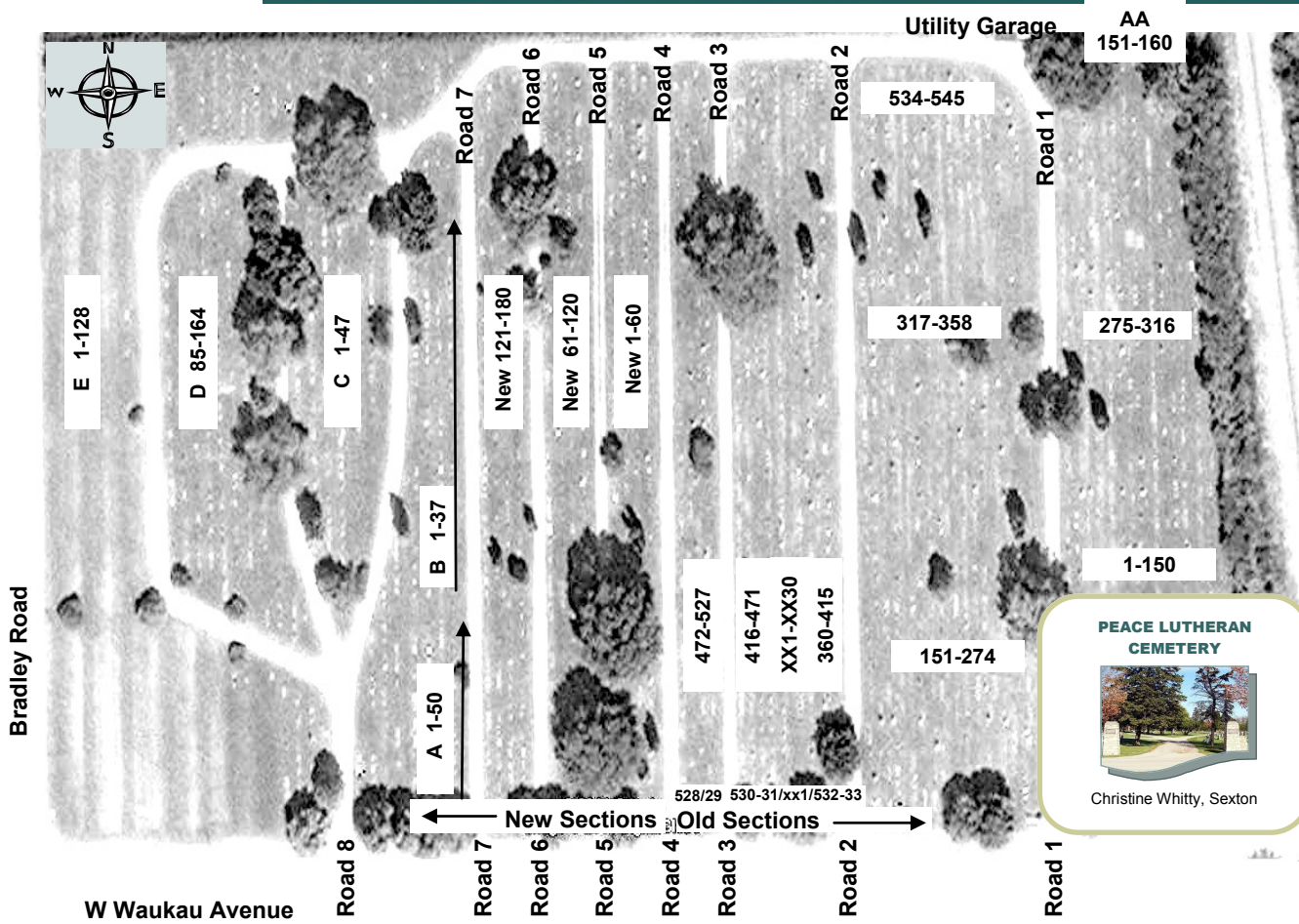

Bradley Road

W Waukau Avenue

Road 8

Road 7

Road 6

Road 5

Road 4

Road 3

Road 2

Road 1

New Sections Old Sections

A 1-50

B 1-37

C 1-47

D 85-164

E 1-128

Road 7

Road 6

Road 5

Road 4

Road 3

Road 2

Road 1

Utility Garage

AA 151-160





Peace Lutheran Cemetery from the East

Looking back, how many times have you wished you had taken care of things when they would have been easier? The loss of a loved one is one of the greatest challenges a person/family may experience. The emotional strain of planning a funeral is stressful, emotional and exhausting.

We at Peace Lutheran Cemetery would like to assist you in making that journey less stressful. Let us help you give the gift of pre-need preparation. We are dedicated to helping you find and purchase a plot to fit your needs. Whether it is a single or family burial plot, we can help you.

**Peace Lutheran Cemetery** is a non-denominational cemetery. All burial sites are sold with perpetual care.

### PEACE LUTHERAN CEMETERY

240 W 9th Ave  
Oshkosh, WI 54902

(Located at 100 W Waukau Ave)

Phone: 920-420-7946  
Fax: 920-321-4823  
E-mail: [plcoffice@new.rr.com](mailto:plcoffice@new.rr.com)

## Semi-Annual Clean-up

All floral arrangements must be removed before the week of April 15 and before the week of October 15 for clean-up. Any arrangements left on grave sites will be removed. You may place your items back on the sites the following week.

## General Information

- \* Lot owners should include the cemetery lot when making their wills.
- \* All digging and planting on any lot will be performed by cemetery personnel.
- \* Certain trees and shrubs may be planted with Cemetery Sexton permission only. All trees and shrubs become the property of the cemetery. The cemetery reserves the right to trim any and all trees and shrubs.
- \* No lots shall be filled without the consent of the Cemetery Sexton.
- \* No enclosure or structure should be placed around any grave.
- \* Peace Lutheran Cemetery is 'loved-one friendly'. We allow the use of ceramic, concrete or metal vases (no glass please), live or artificial flowers, standing or flat headstones and holiday decorations. Flags & service markers are always allowed. No items should be placed so that they interfere with grounds maintenance.
- \* The Cemetery Committee desires to leave the improvement of lots, as far as possible to the taste of the individual owners, but in justice to all, it reserves the right to exclude or remove from any lot, any marker, monument or structure, tree, plant or other object whatever, which may conflict with the regulations, or which it shall consider injurious to the general appearance of the grounds.

## Price List

### Single Grave \$500

Will accommodate:

- 1 casket
- 1 casket & 1 cremation (burial must be first)
- 2 cremations

### Transfer of Ownership \$50

Transfer may be made by surrender of the original deed

### Private Cremation Burial \$450

(Costs for Saturday after 12 noon and Sunday burials are extra, call for more information)

### Regular Burial \$850

(Costs for Saturday after 12 noon and Sunday burials are extra, call for more information)

*All grave sites are sold with perpetual care. The purchase price with perpetual care fees may be paid in interest-free installments provided that the purchaser shall enter into a written agreement with Peace Lutheran Cemetery, and it is agreed that the number of installments shall not exceed a period of two years. The cemetery does not buy lots back.*

*Burial can not take place until lot is paid for in full*